



TRANSFORMER BOBBIN INDUSTRIAL CO.,LTD.

Tel : 86-769-88789999 Fax : 86-769-88789989
 http://tbi-tw.com e-mail : tb6688@ms46.hinet.net

REVISIONS

REV	SYM	DRAFTER	CHECKER	DATE
1		X.H.GU	G.F.YANG	06/09/15
2		F.LU	G.F.YANG	01/21/16
3				

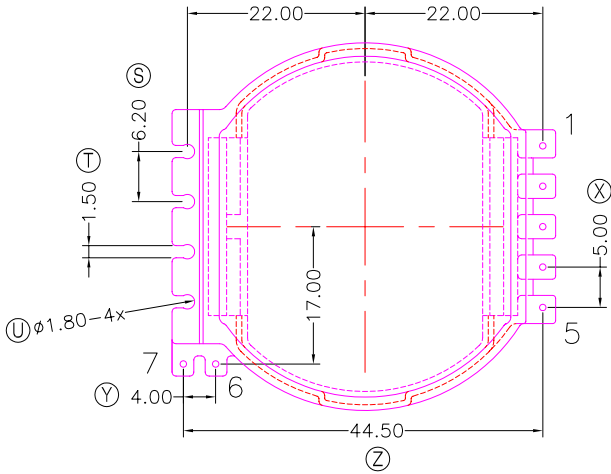
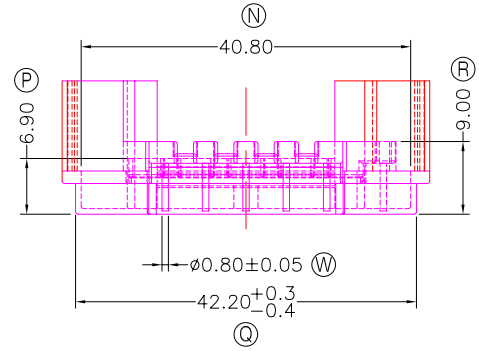
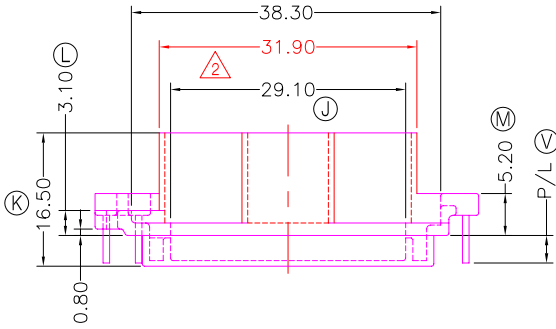
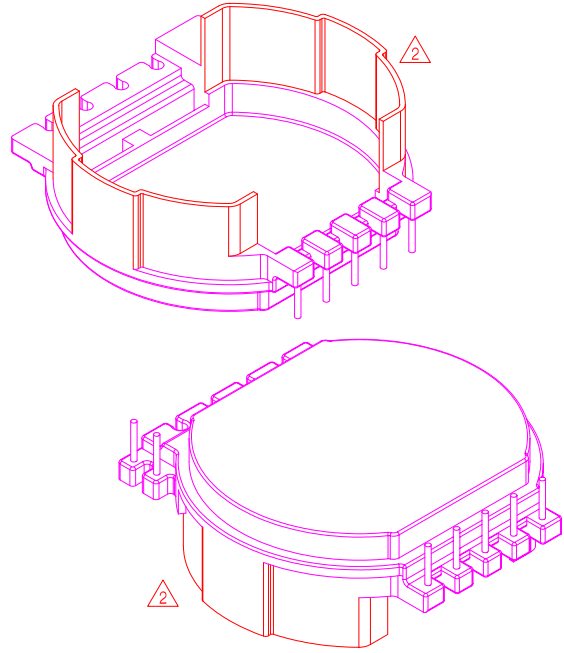
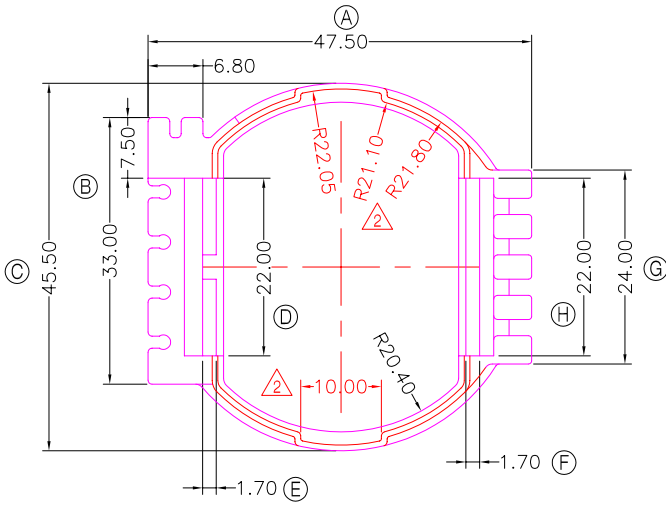

NOTE:

- 1.任意一點強度須2.0kg MIN;
 - 2.耐壓4.0Kv /1.5mA 60S;
 - 3.焊錫前拉力:1.0KG MIN;焊錫後拉力:1.5KG MIN
- 與TBI-239-01491.11(CC40-16.2D-NA-D9-11)配套使用;

DWG NO. CC40-16.2D-7P-CASE-E2-11

PART NO.	MATERIAL (BOBBIN)	MATERIAL (TERMINAL)	TERMINAL (PLATING)	PIN ALLOCATION	NOTE
TBI-239-01521.1106	PM-9630	CP WIRE	Sn	ALL PIN P/L=3.4±0.2	S
TBI-239-01521.1116	PM-9630	CP WIRE	Sn	ALL PIN P/L=5.0±0.2	暫無刀模 H

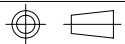

TOLERANCE: 0<L<=4;±0.1 4<L<=16;±0.2 16<L<=50;±0.3

UNIT : m / m

SCALE 1 : 1

Finish: 1. PB wire Immersion Sn on terminal : Thickness:Sn plating,100%,5 μm (200 μ inches) min,Base nickel 0.625 μm (25 μ inches) min.
 2. CP wire Immersion Sn on terminal : Thickness:Sn plating,100%,5 μm (200 μ inches) min.
 3. Coplanarity deviation: 0.10 mm (0.004 inches) max.

REV 2