

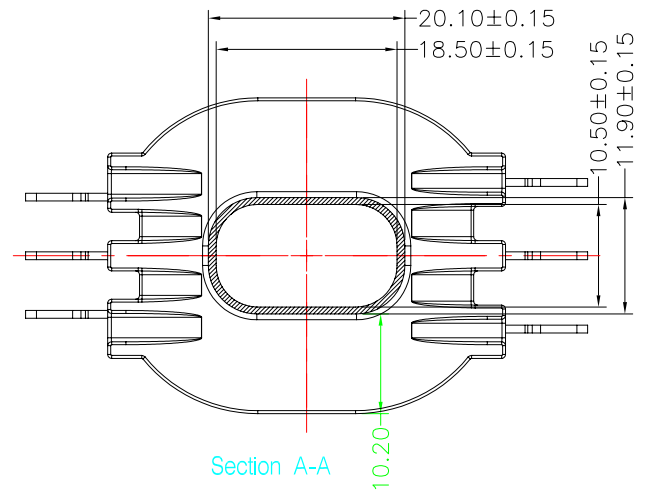

TRANSFORMER BOBBIN
INDUSTRIAL CO.,LTD.

Tel : 86-769-88789999 Fax : 86-769-88789989
http:// tbi-tw.com e-mail : tb6688@ms46.hinet.net

REVISIONS				
REV	SYM	DRAFTER	CHECKER	DATE
1		YAN.TANG	G.F.YANG	04/22/10
2				
3				

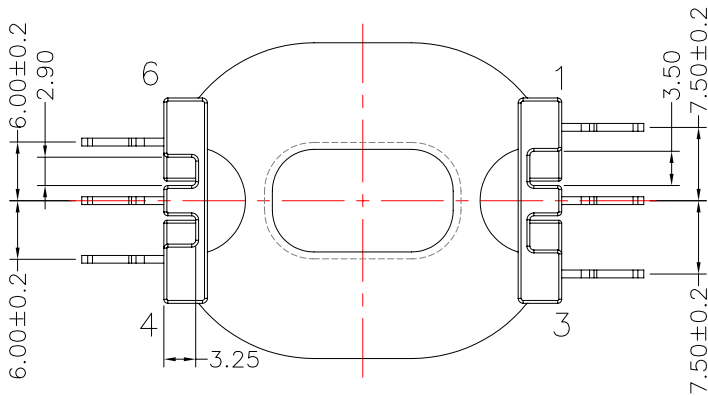
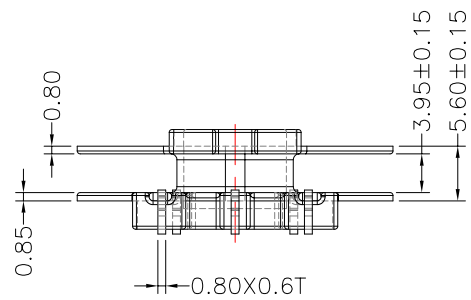
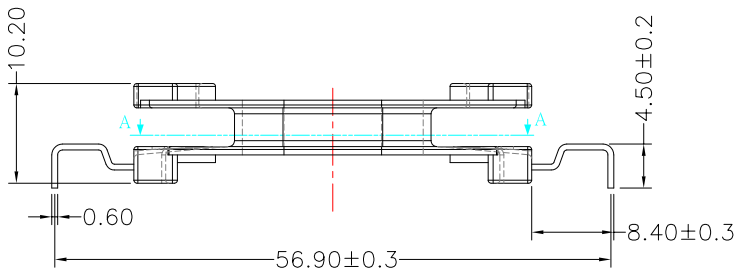
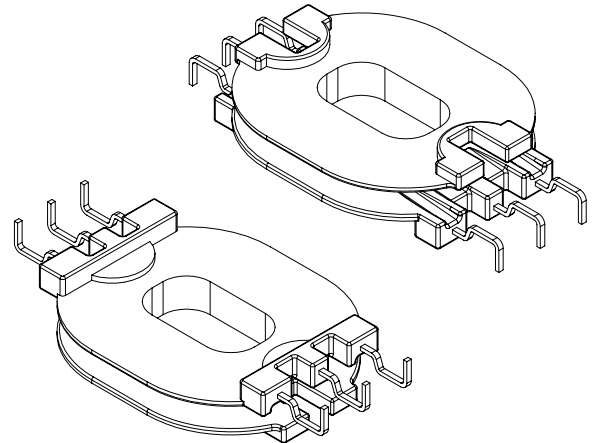
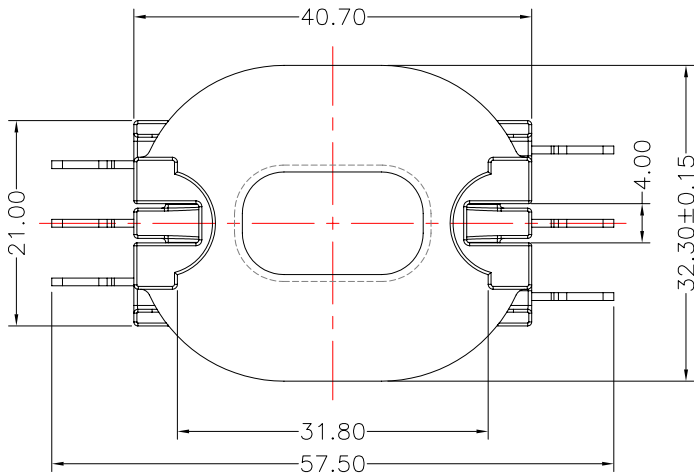

NOTE:
1. WINDING SPACE: $10.2\text{mm} \times 3.95\text{mm} = 40.29\text{mm}^2$

DWG NO. ATQ38-11.4-6P-THT-0B-12

PART NO.	MATERIAL (BOBBIN)	MATERIAL (TERMINAL)	TERMINAL (PLATING)	PIN ALLOCATION	NOTE
TBI-238-32021.1206	PM-9820	CP WIRE	Sn	ALL PIN	

TOLERANCE: $0 < L \leq 4: \pm 0.1$ $4 < L \leq 16: \pm 0.2$ $16 < L \leq 63: \pm 0.3$ UNIT : m / m SCALE 1 : 1

Finish: 1. PB wire Immersion Sn on terminal : Thickness:Sn plating, $100.5 \mu\text{m}$ ($200 \mu\text{inches}$) min, Base nickel $0.625 \mu\text{m}$ ($25 \mu\text{inches}$) min.
2. CP wire Immersion Sn on terminal : Thickness:Sn plating, $100.5 \mu\text{m}$ ($200 \mu\text{inches}$) min.
3. Coplanarity deviation: 0.10 mm (0.004 inches) max.

REV 1